



PORSCHE 911 991 MK1 GT3 RS | PORSCHE 911 991 MK1-MK2 TURBO

SFORZA CARBON FIBER SIDE AIR INTAKES INSTALL

We recommend to refer to professional qualified personnel for install operations.

Before starting with operations make sure to:

- To wear protective gloves
- To have a cleaner solvent free
- To have a polyurethane adhesive with sealant gun (DOW betaseal 1407 or similar)
- To have masking tape & suction clamps
- To have read and understand all the install operations



1. Apply a stripe of masking tape around the air ducts edges to protect the bodywork paint and prevent possible damages.
2. Remove the OEM plastic air intakes. **Put the oem side intake away, these are being replaced by carbon fiber ones.**

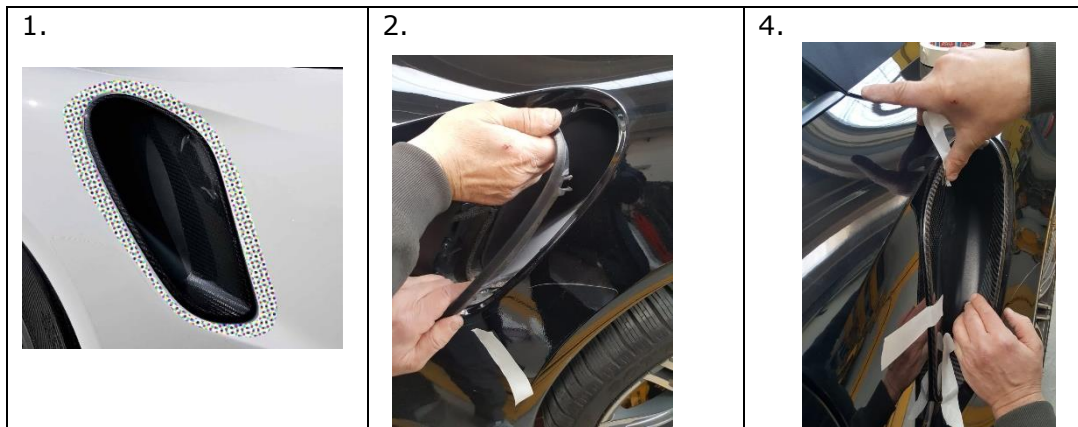

3. Clean the bonding surfaces with a proper cleaner:
 - Internal side of carbon side intakes
 - Vehicle air ducts where the oem plastic intakes were removed
4. Check placement of carbon air intakes in the air ducts and use masking tape to hold the parts in position.
5. Apply a stripe of adhesive polyurethane glue on the internal edge of the Carbon intakes where the masking tape is showed in pictures below.





5. Bond Carbon intakes on vehicle air ducts and use masking tape & suction clamps to hold the parts in the correct position for the time needed to let the polyurethane adhesive glue dry. We recommend to wait at least 5 hours before removing the paper tape & suction clamps. (Adhesive drying time depends by the adhesive glue type).
6. Remove the paper tape installed around the air intakes at point 1.

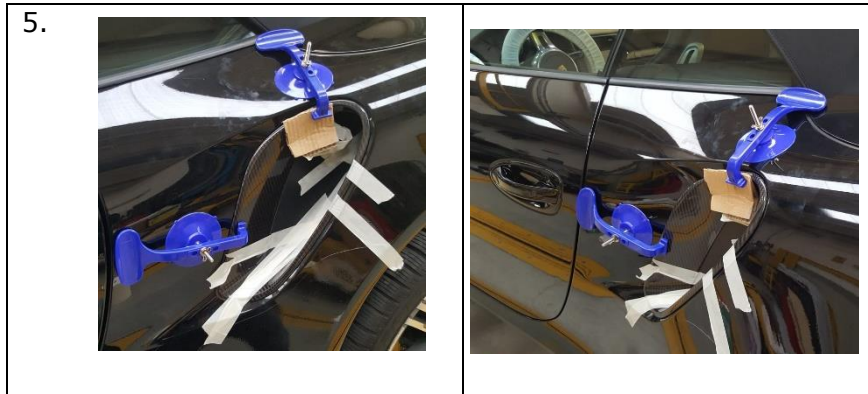

***Thank you for purchasing Sforza
Carbon 911 991 Carbon side Air Intakes!***

